

Item No.	Type	Sub	Part No.	Description	Qty	Unit
1	1		6164500700	GRIP	1	PC.
	2		273673-4	GRIP	1	PC.
2	1		6165028001	CONTROL LEVER ASSY	1	PC.
		INC.		Item No. 3, 5-12		
	2		126043-5	* CONTROL LEVER ASSY	1	PC.
		INC.		* Item No. 3, 5-12		
	3		126569-7	* CONTROL LEVER ASSY	1	PC.
		INC.		* Item No. 3, 5-10, 12		
3	1		6195018111	WIRE SET	1	PC.
		INC.		Item No. 4		
	2		126051-6	WIRE ASSEMBLY	1	PC.
		INC.		Item No. 4		
4	1		6195018121	CONTROL CABLE	1	PC.
	2		168688-3	CONTROL CABLE	1	PC.
5	1		6195018050	TUBE	1	PC.
	2		412104-0	TUBE	1	PC.
6	1		0043505300	SCREW ASSEMBLY M5X30 W/SW	3	PC.
	2		266708-8	PAN HEAD SCREW M5X30 W/SW	3	PC.
7	1		6195018060	LEVER SWITCH	1	PC.
	2		452993-1	SWITCH LEVER	1	PC.
8	1		6195018130	SWITCH PLATE	1	PC.
	2		346512-2	SWITCH PLATE	1	PC.
9	1		6195018030	LEVER	1	PC.
	2		452994-9	LEVER	1	PC.
10	1		6195018040	SPRING	1	PC.
	2		233592-6	SPRING	1	PC.
11	1		6165028030	* TAPPING SCREW M5X12	1	PC.
	2		266722-4	* TAPPING SCREW M5X12	1	PC.
12	1		002-18050-00	NUT M5	3	PC.
	2		264035-7	HEX. NUT M5	3	PC.
14	1		0043505300	SCREW ASSEMBLY M5X30 W/SW	3	PC.
	2		266708-8	PAN HEAD SCREW M5X30 W/ SW	3	PC.
15			0021805003	NUT M5	3	PC.
16	2		6169512800	CAUTION LABEL	1	PC.
	3		893204-9	CAUTION LABEL	1	PC.
17	1		6161019000	* FLEXIBLE PIPE UNIT	1	PC.
		INC.	6161026000	* PIPE ASSEMBLY	1	PC.
		INC.		* Item No. 18		
	2		6161027000	* FLEXIBLE PIPE UNIT	1	PC.
		INC.	6161026000	* PIPE ASSEMBLY	1	PC.
		INC.		* Item No. 18		
	3		126040-1	* FLEXIBLE PIPE ASSEMBLY	1	
		INC.	6161026000	* PIPE ASSEMBLY	1	PC.
		INC.		* Item No. 18		
18	1		6161501300	FLEXIBLE SHAFT	1	PC.
	2		6161027020	FLEXIBLE SHAFT	1	PC.
19	1		6163004000	GEAR CASE ASSY	1	PC.
		INC.		Item No. 20-27		
	2		6163005000	GEAR CASE ASSY	1	PC.
		INC.		Item No. 20-27		
	3		126041-9	GEAR CASE ASSEMBLY	1	PC.
		INC.		Item No. 20-27		
20	1		6163500800	CUTTER SHAFT	1	PC.
	2		6163003020	CUTTER SHAFT	1	PC.
21	1		6163500600	BEARING BALL #608ZZ	2	PC.
	2		6163002031	BALL BEARING 608LLU	2	PC.
22	1		6163500700	SPACER	1	PC.
	2		6163003041	SPACER	1	PC.
23			0017005100	CROSS RECESS HEAD BOLT	1	PC.
24	1		6163500900	WASHER	1	PC.
	2		6163002051	WASHER	1	PC.
25	1		6163501000	WASHER SPRING	1	PC.
	2		6163002061	SPRING WASHER	1	PC.
26	1		6163501101	* RECEIVE WASHER	1	PC.
	2		6168500800	* RECEIVE WASHER	1	PC.

Item No.	Type	Sub	Part No.	Description	Qty	Unit
27			6163002121	BOLT ASS'Y	1	PC.
30	1		6161501500	SPACER	1	PC.
	2		331959-3	SPACER	1	PC.
31	1		5103502801	SPACER GASKET	1	PC.
	2		442177-9	AIR CLEANER GASKET	1	PC.
32	1		0140059500	SCREW M5X25	2	PC.
	2		266700-4	PAN HEAD SCREW M5X25	2	PC.
33	1		5233014000	INSULATOR COMPLETE	1	PC.
	2		141056-5	INSULATOR COMPLETE	1	PC.
34	1		6165500201	WIRE	1	PC.
	2		638784-6	WIRE	1	PC.
35	1		5193500501	INSULATOR GASKET	1	PC.
	2		442175-3	INSULATOR GASKET	1	PC.
36	1		0119059730	SOCKET HEAD BOLT M5X20	2	PC.
	2		266814-9	HEX SOCKET HEAD BOLT M5X20	2	PC.
	3		922233-6	HEX SOCKET HEAD BOLT M5X20	2	PC.
37	1		5197500100	PLUG CAP COVER	1	PC.
	2		424445-2	PLUG CAP COVER	1	PC.
39	1		5191500901	CYLINDER	1	PC.
	2		318785-7	CYLINDER	1	PC.
40	1		5195503000	COVERCYLINDER HD	1	PC.
	2		452973-7	CYLINDER COVER	1	PC.
41	1		6279505700	MAKITA LOGO LABEL	1	PC.
	2		801B04-5	MAKITA LOGO LABEL	1	PC.
42	1		0150059790	TAPPING SCREW 5X14	1	PC.
	2		266702-0	TAPPING SCREW 5X14	1	PC.
43	1		0655009870	PLUG CAP	1	PC.
	2		424337-5	PLUG CAP	1	PC.
44	1		0654009931	PLUG CAP SPRING	1	PC.
	2		324891-8	PLUG CAP SPRING	1	PC.
45	1		0851089950	TUBE	1	PC.
	2		444021-6	TUBE	1	PC.
46	1		5197018000	WIRE COMPL	1	PC.
	2		141049-2	WIRE COMPLETE	1	PC.
47			911128-8	PAN HEAD SCREW M4X16	2	PC.
48	1		5197011010	IGNITION COIL	1	PC.
	2		168683-3	IGNITION COIL	1	PC.
49	1		0119059520	SOCKET HEAD BOLT M5X40	2	PC.
	2		266440-4	HEX SOCKET HEAD BOLT M5X40	2	PC.
50	1		5193001002	EXHAUST MUFFLER	1	PC.
	2	INC.		Item No. 51		
			168679-4	EXHAUST MUFFLER	1	PC.
		INC.		Item No. 51		
51			5193001050	SPARK ARRESTER	1	PC.
52	1		5193500002	INSULATORMUFFLER	1	PC.
	2		168680-9	MUFFLER GASKET	1	PC.
53	1		5191500301	CYLINDER GASKET	1	PC.
	2		442173-7	CYLINDER GASKET	1	PC.
54	1		5212500500	PISTON RING	1	PC.
	2		257320-5	PISTON RING	1	PC.
55	1		0565089970	CLIP	1	PC.
	2		233976-8	CLIP	1	PC.
56	1		5192501701	PISTON	1	PC.
	2		318831-6	PISTON	1	PC.
57	1		5192500500	PISTON PIN	1	PC.
	2		268277-5	PISTON PIN	1	PC.
58	1		0565089970	CLIP	1	PC.
	2		233976-8	CLIP	1	PC.
59	1		5192001003	CRANKSHAFT COMPLETE	1	PC.
	2		141047-6	CRANK SHFT COMPLETE	1	PC.

Item No.	Type	Sub	Part No.	Description	Qty	Unit
60			911128-8	PAN HEAD SCREW M4X16	3	PC.
61	1		5195009000	REWIND STARTER	1	PC.
		INC.		Item No. 62-69		
	2		126037-0	RECOIL STARTER ASSEMBLY	1	PC.
		INC.		Item No. 62-69		
62	1		5195500000	PULLEY	1	PC.
	2		168483-1	PULLEY	1	PC.
63	1		5195002060	SET SCREW	1	PC.
	2		266585-8	TAPPING SCREW 5X12	1	PC.
64	1		5195002100	SWING ARM	1	PC.
	2		325923-4	SWING ARM	1	PC.
65	1		5195002110	COLLAR	1	PC.
	2		451938-6	COLLAR	1	PC.
66	1		5195002030	REEL	1	PC.
	2		452972-9	REEL	1	PC.
67	1		5195002050	SPIRAL SPRING	1	PC.
	2		234220-6	SPIRAL SPRING	1	PC.
68	1		5225004020	HANDLE	1	PC.
	2		424319-7	STARTER KNOB	1	PC.
70	1		6169511400	MODEL LABEL	1	PC.
	2		893199-6	MODEL NO. LABEL	1	PC.
71			5191004001	CRANK CASE ASS'Y	1	PC.
		INC.		Item No. 72-75		
72	1		0440109980	OIL SEAL	2	PC.
	2		213638-4	OIL SEAL	2	PC.
73	1		5191500400	CRANKCASE GASKET	1	PC.
	2		442174-5	CRANK CASE GASKET	1	PC.
74	1		0600109980	BALL BEARING 6000	2	PC.
	2		210086-8	BALL BEARING 6000	2	PC.
	3		211064-1	BALL BEARING 6000	2	PC.
75	1		0140059520	SCREW M5X25	3	PC.
	2		266701-2	PAN HEAD SCREW M5X25	3	PC.
76	1		5197017010	FLYWHEEL	1	PC.
	2		318791-2	FLY WHEEL	1	PC.
77	1		6192006000	CLUTCH	1	PC.
	2		126049-3	CLUTCH ASSEMBLY	1	PC.
78	1		6162011000	CLUTCH DRUM COMPLETE	1	PC.
	2		141050-7	CLUTCH DRUM COMPLETE	1	PC.
79	1		6191006001	CLUTCH CASE COMPLETE	1	PC.
	2		141058-1	CLUTCH CASE COMPLETE	1	PC.
80	1		0031510000	OUTER SNAP RING 10	1	PC.
	2		961006-2	RETAINING RING S-10	1	PC.
81	1		0119059880	SOCKET HEAD BOLT M5X25	1	PC.
	2		266712-7	HEX SOCKET HEAD BOLT M5X25	1	PC.
82	1		6191500203	PIPE DAMPER	1	PC.
	2		424461-4	PIPE DAMPER	1	PC.
83	1		6191501300	PIPE BRACKET	1	PC.
	2		318792-0	PIPE BRACKET	1	PC.
84	1		0566059980	CLAMP	1	PC.
	2		345963-6	CLAMP	1	PC.
85	1		0150059780	TAPPING SCREW M5X20	3	PC.
	2		266713-5	TAPPING SCREW 5X20	3	PC.
86	1		0119059850	SOCKET HEAD BOLT M5X14	1	PC.
	2		266711-9	HEX SOCKET HEAD BOLT M5X14	1	PC.
87	1		5256059000	FUEL TANK CAP COMPLETE	1	PC.
		INC.		Item No. 88,89		
	2		168668-9	FUEL TANK CAP COMPLETE	1	PC.
		INC.		Item No. 88,89		
88	1		5256058000	FUEL TANK CAP	1	PC.
	2		452920-8	FUEL TANK CAP	1	PC.

Item No.	Type	Sub	Part No.	Description	Qty	Unit
89	1		5256067000	STRAP	1	PC.
	2		140436-2	STRAP COMPLETE	1	PC.
90	1		5196500003	FUEL TANK	1	PC.
	2		452989-2	FUEL TANK	1	PC.
91	1		0851159850	TUBE	1	PC.
	2		162329-3	TUBE	1	PC.
92	1		0561059990	HOSE CLAMP	1	PC.
	2		345920-4	HOSE CLAMP	1	PC.
93	1		5236503900	FILTER	1	PC.
	2		163447-0	GASOLINE FILTER	1	PC.
94	1		5036500200	PLATE	1	PC.
	2		424102-2	PLATE	1	PC.
95	1		5036500300	PLATE	1	PC.
	2		424103-0	PLATE	1	PC.
96	1		5193500101	PLATE	1	PC.
	2		452988-4	MUFFLER PLATE	1	PC.
97	1		5216500200	DAMPER	2	PC.
	2		424446-0	DAMPER	2	PC.
98	1		5196036000	CARBURETOR	1	PC.
		INC.		Item No. 99-126		
98	2		168681-7	CARBURETOR	1	PC.
		INC.		Item No. 99-126		
99	1		5196019240	ADJUST SCREW	1	PC.
	2		266717-7	ADJUST SCREW	1	PC.
100	1		5196019310	SCREW	2	PC.
	2		266719-3	TAPPING SCREW M3X7	2	PC.
101	1		5196019450	LEVER END	1	PC.
	2		326099-0	END LEVER	1	PC.
102	1		5196019460	WASHER	1	PC.
	2		267837-0	WASHER	1	PC.
103	1		5196036010	STARTER LEVER	1	PC.
	2		452976-1	STARTER LEVER	1	PC.
104	1		5196036020	STARTER SPRING	1	PC.
	2		234221-4	STARTER SPRING	1	PC.
105	1		5196019250	SLOW STOP SCREW	1	PC.
	2		266718-5	TAPPING SCREW M3X16	1	PC.
106	1		5196019510	E-RING	1	PC.
	2		259051-2	E-RING 4.5	1	PC.
107	1		5196019220	O-RING	1	PC.
	2		213630-0	O-RING 18	1	PC.
108	1		5196019150	O-RING	1	PC.
	2		213629-5	O-RING 2	1	PC.
109	1		5196032010	MAIN JET	1	PC.
	2		326100-1	MAIN JET	1	PC.
110	1		5196019410	O-RING	1	PC.
	2		213631-8	O-RING 4	1	PC.
111	1		5196019360	CHECK VALVE ASSY	1	PC.
	2		126052-4	CHECK VALVE ASSEMBLY	1	PC.
112	1		5196019420	GUIDE PLATE	1	PC.
	2		346509-1	GUIDE PLATE	1	PC.
113	1		5196019430	SCREW	1	PC.
	2		266721-6	TAPPING SCREW M2.6X6	1	PC.
114	1		5196019040	DIAPHRAGM ASSY	1	PC.
	2		126038-8	DIAPHRAGM ASSEMBLY	1	PC.
115	1		5196019050	DIAPHRAGM COVER	1	PC.
	2		346513-0	DIAPHRAGM COVER	1	PC.
116	1		5196019060	SCREW	2	PC.
	2		266715-1	TAPPING SCREW M3X8	2	PC.
117	1		5196019110	PUMP PACKING	1	PC.
	2		442176-1	PUMP PACKING	1	PC.
118	1		5196019120	PUMP DIAPHRAGM	1	PC.
	2		424460-6	PUMP DIAPHRAGM	1	PC.

Item No.	Type	Sub	Part No.	Description	Qty	Unit
119	1		5196019350	PUMP PLATE	1	PC.
	2		346508-3	PUMP PLATE	1	PC.
120	1		5196019330	FILTER	1	PC.
	2		352018-0	FILTER	1	PC.
121	1		5196019130	PUMP PACKING	1	PC.
	2		442178-7	PUMP PACKING	1	PC.
122	1		5196019340	PUMP COVER	1	PC.
	2		452975-3	PUMP COVER	1	PC.
123	1		5246009030	COMBINATION VALVE	1	PC.
	2		452977-9	COMBINATION VALVE	1	PC.
124	1		5246009040	PRIMING PUMP	1	PC.
	3		424462-2	PRIMING PUMP	1	PC.
125	1		5196019320	PRIMING PUMP PLATE	1	PC.
	3		346507-5	PRIMING PUMP PLATE	1	PC.
126	1		5196019140	SCREW	4	PC.
	2		266716-9	TAPPING SCREW M3X18	4	PC.
127	1		5193017040	O-RING	1	PC.
	2		213632-6	O-RING 14.8	1	PC.
128	1		5193018010	PLATEAIR CLEANER ASSY	1	PC.
	2		126036-2	AIR CLEANER PLATE ASSEMBLY	1	PC.
129	1		0043105600	PAN HEAD SCREW M5X60	2	PC.
	2		266695-1	PAN HEAD SCREW M5X60	2	PC.
130	1		5193017030	ELEMENTAIR CLEANER	1	PC.
	2		443168-3	AIR CLEANER PLATE ELEMENT	1	PC.
131	1		5193018020	CASEAIR CLEANER	1	PC.
	2		452971-1	AIR CLEANER CASE	1	PC.
132	1		0140059480	SCREW ASS'Y M5X14	1	PC.
	2		266809-2	P.H.SCREW M5X14 WITH WR	1	PC.
	3		911218-7	PAN HEAD SCREW M5X14	1	PC.
133	1		6259514700	CAUTION LABEL	1	PC.
	2		808723-2	CAUTION LABEL	1	PC.

#### **ACCESSORIES**

- See Catalogue or visit [www.makita.ca](http://www.makita.ca) for more accessories -

A01			6169030000	TOOL KIT(INCL. HEX WRENCH)	1	SET
A02			0717049990	HEX WRENCH	1	PC.
A03	2		6168020000	BUMP&FEED (NYLON) CUTTING HEAD (RH) (See Parts breakdown 6168020000)	1	PC.
		INC.	A-89246	HOUSING RH (BLACK)	1	PC.
		INC.	B-03090	NUT M8 (R.H) FOR BF4L	1	PC.
		INC.	A-15992	EYELET FOR U.AUTO & BF4L, 2PC/SET	1	SET
		INC.	B-03056	TAP SPRING FOR BF4L	1	PC.
		INC.	A-89252	COVER (BLACK)	1	PC.
		INC.	B-03137	SPOOL(W/O NYLON CORD)FOR BF4L	1	PC.
		INC.	A-89193	NYLON LINE,DIA 2.4MMX3M	1	PC.
A04	1		6164010000	HANDLE ASSY	1	PC.
		INC.		Item No. 14,15		
	2		126042-7	HANDLE ASSEMBLY	1	PC.
		INC.		Item No. 14,15		
A05	1		6168016001	PROTECTOR ASSY	1	PC.
				* (Components of each parts are not available as indivisual sales)		
	2		6168016002	PROTECTOR ASSY	1	PC.
				* (Components of each parts are not available as indivisual sales)		
				PROTECTOR ASSY		
				* (Components of each parts are not available as indivisual sales)		
	3		126045-1		1	PC.
A06			965 603 014	SPARK PLUG (BPMR7A)	1	PC.
A07	1		5255016020	STARTER ROPE	1	PC.
	2		444024-0	STARTER ROPE	1	PC.
A08			B-60121	ULTRA AUTO 4X(RH) ASSY(RH) (See Parts breakdown "Trimmer Head")	1	PC.
A09			A-90124	BUMP & FEED HEAD ASSY (RH) (See Parts breakdown "Trimmer Head")	1	PC.
A10			B-02951	TRIMMEDR HEAD, MANUAL (Component parts are not available)	1	PC.



**SERVICE CHANGES**

**1. Changes on Flexible Shaft Unit and Gear Case Complete**

Item No.	Description	Type 1	Type 2	Type 3	Type 1 > 2 Note:
17	Flexible pipe unit	6161019000	6161027000	126040-1	Item No. 17 & 19 are interchangeable as a set.
17	Flexible shaft	1	6161027020	6161027020	Component of Item No.17
17	Gear case assy	6163004000	6163005000	126041-9	Item No. 17 & 19 are interchangeable as a set.
17	Gear case assy		6161027020		
17		3	6163005000		126569-7
17		3	6161027020	6161027020	
17	Ball bearing	6163500600	6163002031	6163002031	Component of Item No.19
17	Spacer	6163500700	6163003041	6163003041	
17	Washer	6163500900	6163002051	6163002051	
17	Washer spring	6163501000	6163002061	6163002061	
26	Receive washer	6163501101	6168500800	6168500800	

Type 1 - 2 parts are completely interchangeable as a set (See Type 1 > 2 Note) (T/I# Y05741)

Type 2 - 3 parts are interchangeable each other

**2. Changes on Protector Assy**

Item No.	Description	Type 1	Type 2	Type 3
A05	Protector Assy	6168004003	6168004004	126045-1

(T/I# Y05553)

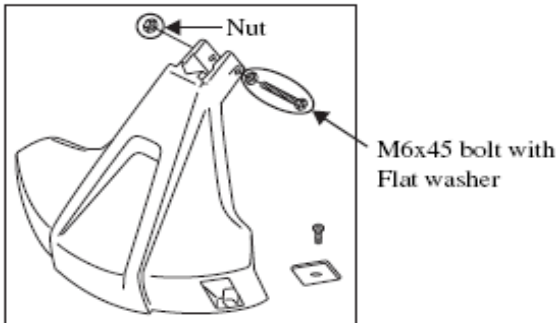

Type 1

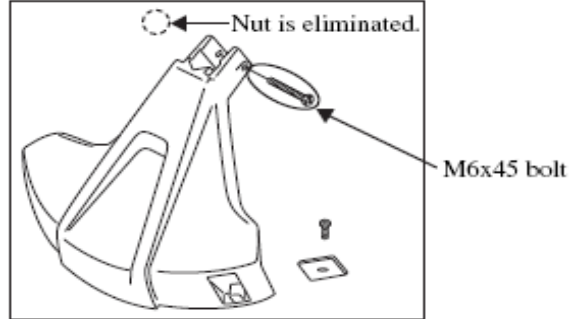

Type 2

**3. Changes on Tapping screw M5x12 for Controller assembly**

(T/I#A4593)

Item No.	Description	Type 1	Type 2
2	Controller assembly	126043-5	126569-7
INC.		Item 3,5-12	Item 3,5-10, 12
11	Tapping screw M5x12	266722-4	266928-4

Above parts are completely interchangeable as a set.

